

- FLOOR PLAN NOTES**
1. CONTRACTOR TO FIELD VERIFY ALL DIMENSIONS AND REPORT ANY DISCREPANCIES TO ARCHITECT BEFORE PROCEEDING WITH WORK.
 2. EXTERIOR DIMENSIONS ARE FACE OF MASONRY, AND CENTERLINE OF COLUMNS UNLESS NOTED OTHERWISE. INTERIOR PARTITIONS ARE DIMENSIONED TO FACE OF STUD UNLESS OTHERWISE NOTED.
 3. REFER TO SHEET G0-0 FOR SYMBOLS AND ABBREVIATIONS.
 4. REFER TO SHEET A1-3 AND A1-4 FOR REFLECTED CEILING PLAN.
 5. REFER TO SHEET A5-1 FOR DOOR SCHEDULES, A5-2 AND A5-3 FOR WINDOW ELEVATIONS.
 6. REFER TO SHEET A5-3 FOR ROOM FINISH SCHEDULE.
 7. REFER TO SHEET A5-1 FOR WALL TYPES.
 8. HINGE SIDE DIMENSION SHALL BE 4" FROM WALL TO DOOR FRAME UNLESS OTHERWISE NOTED.
 9. PROVIDE CEILING INSULATION 4" EITHER SIDE OF WALL AT ALL WALLS THAT TERMINATE BELOW UNDERSIDE OF ROOF DECK.
 10. CONTRACTOR TO INCLUDE IN BID R-30 BATT INSULATION AT ROOF DECK THROUGHOUT (IF NONE EXISTS).
 11. CONTRACTOR TO INCLUDE IN BID GYP. BD. FINISH AND R-19 BATT INSULATION AT ALL EXTERIOR WALLS OF SUITE (IF NONE EXISTS).

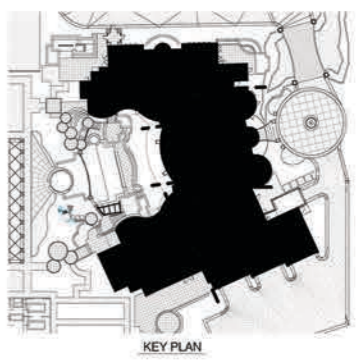

REVISIONS	
NO.	DESCRIPTION
1	CITY COMMENTS
2	OWNER COMMENTS
3	CITY COMMENTS
4	PLAN CLARIFICATIONS

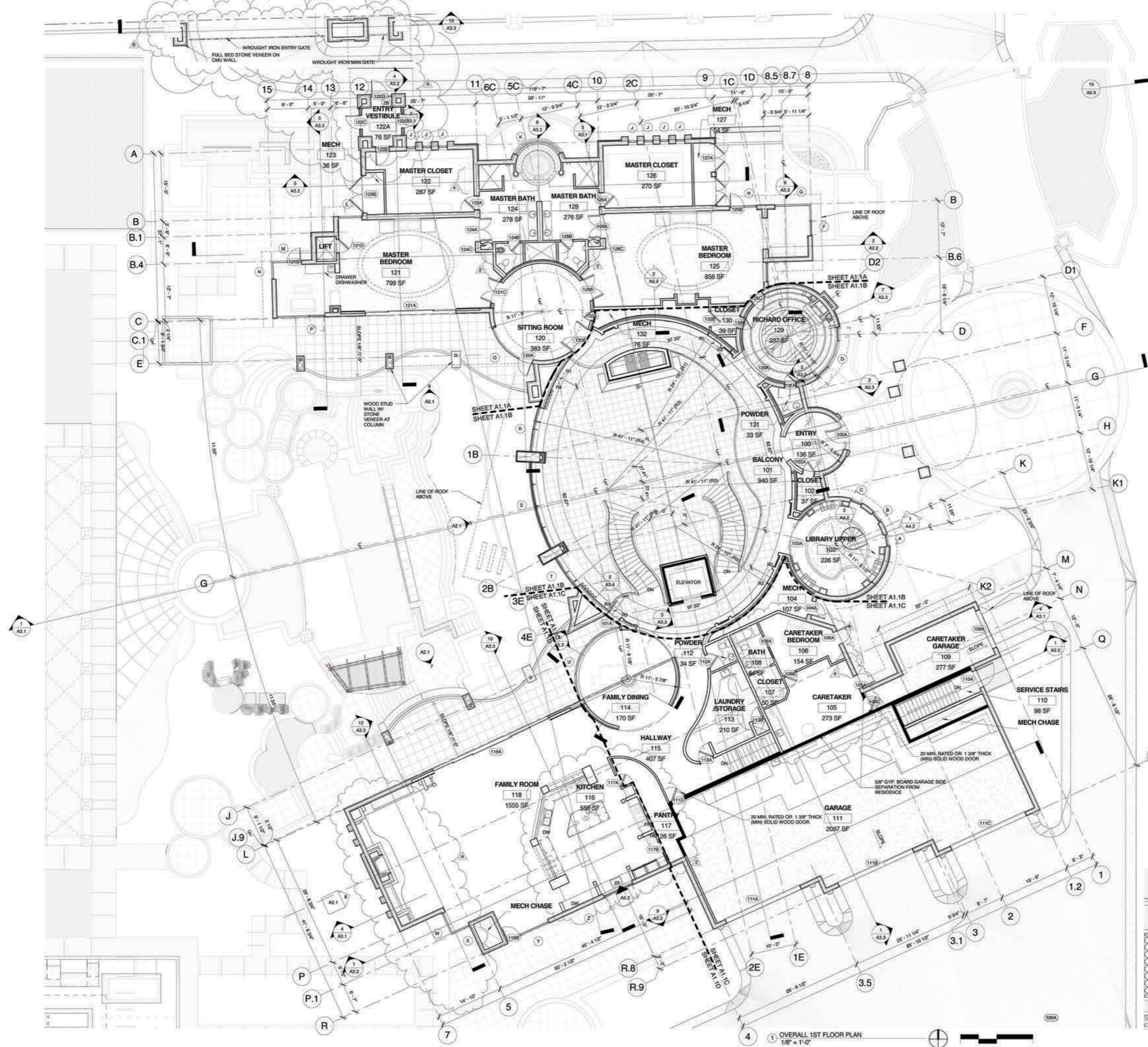

1 OVERALL 1ST FLOOR PLAN
1/8" = 1'-0"

C:\Users\clayton\Documents\Clayton Estate CD Final.rvt
11/12/2009 9:06:38 AM